

The Mycenaean Palaces

Map of the main Mycenaean palatial structures

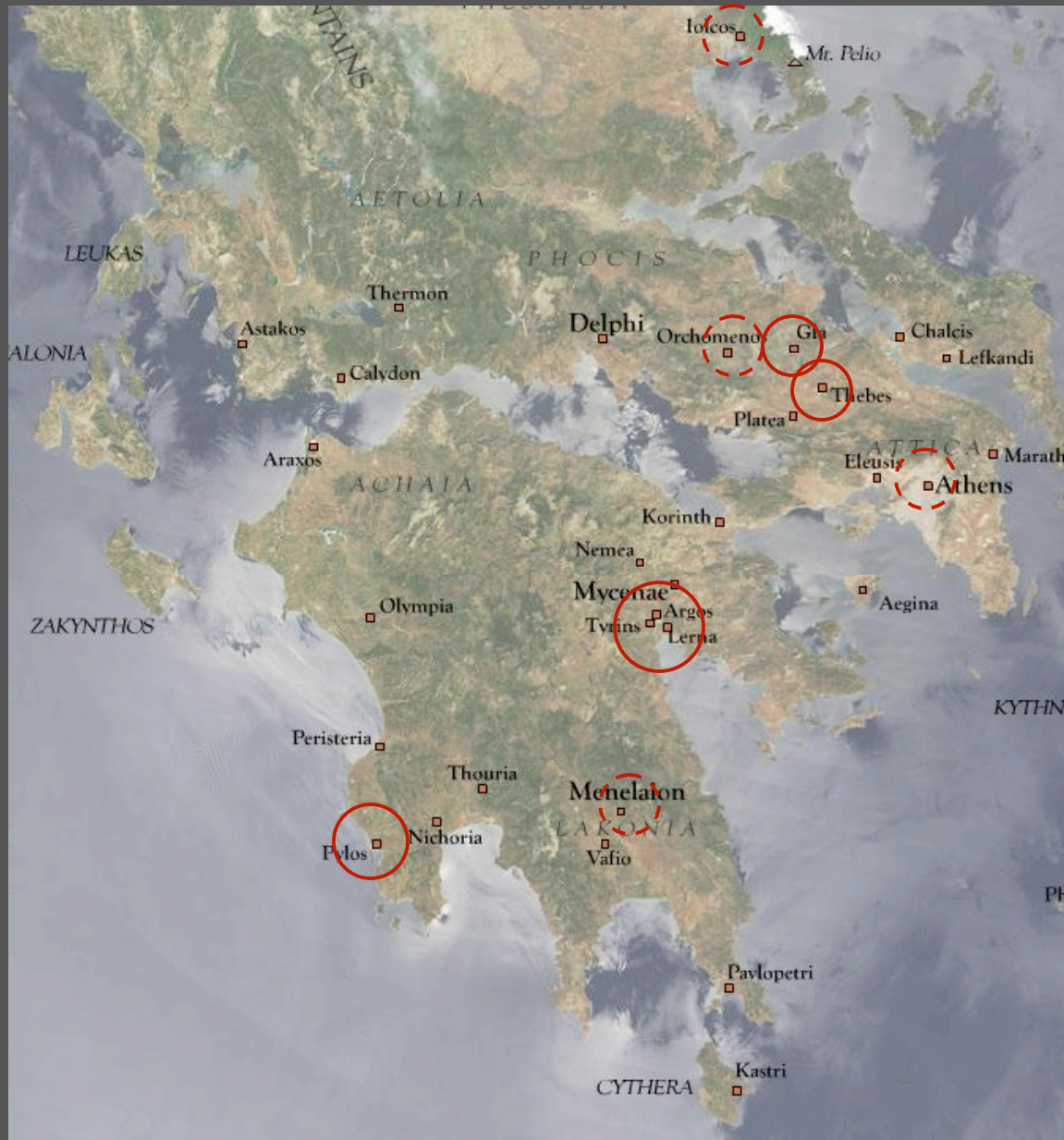

Argolid:
Mycenae, Tiryns

Messenia:
Pylos

Laconia:
Menelaion (probably)

Attica:
Athens (probably)

Boeotia:
Thebes, Gla,
Orchomenos (probably)

Thessaly:
Iolkos (possibly)

Mycenaean palaces and the fortification systems

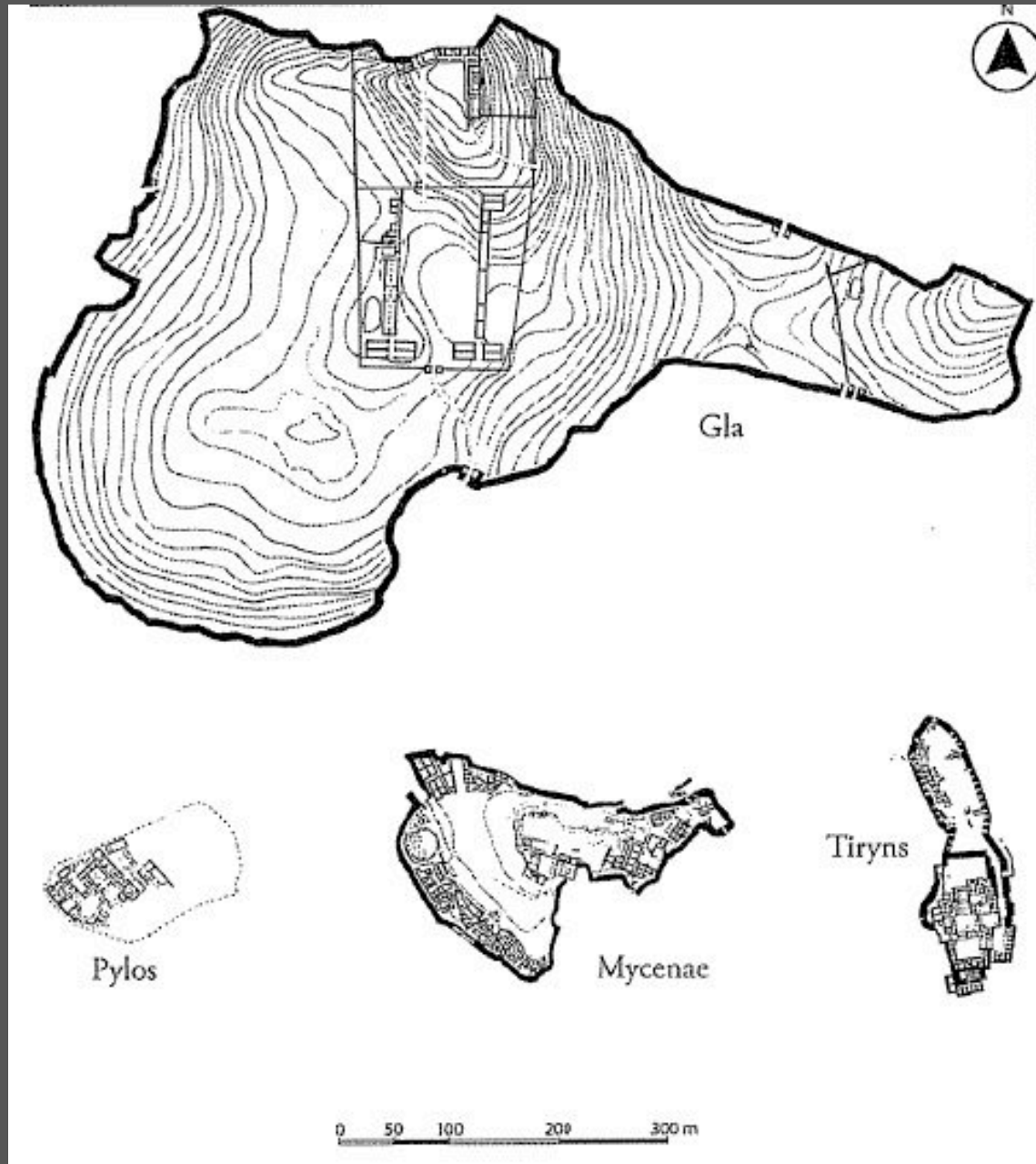

View of the Menelaion hill from NE



LH IIIB Mansion at Menelaion



Gla: view of the citadel from the east



House on south slope of citadel at Gla



Plan of the site of Pylos (“Palace of Nestor”)

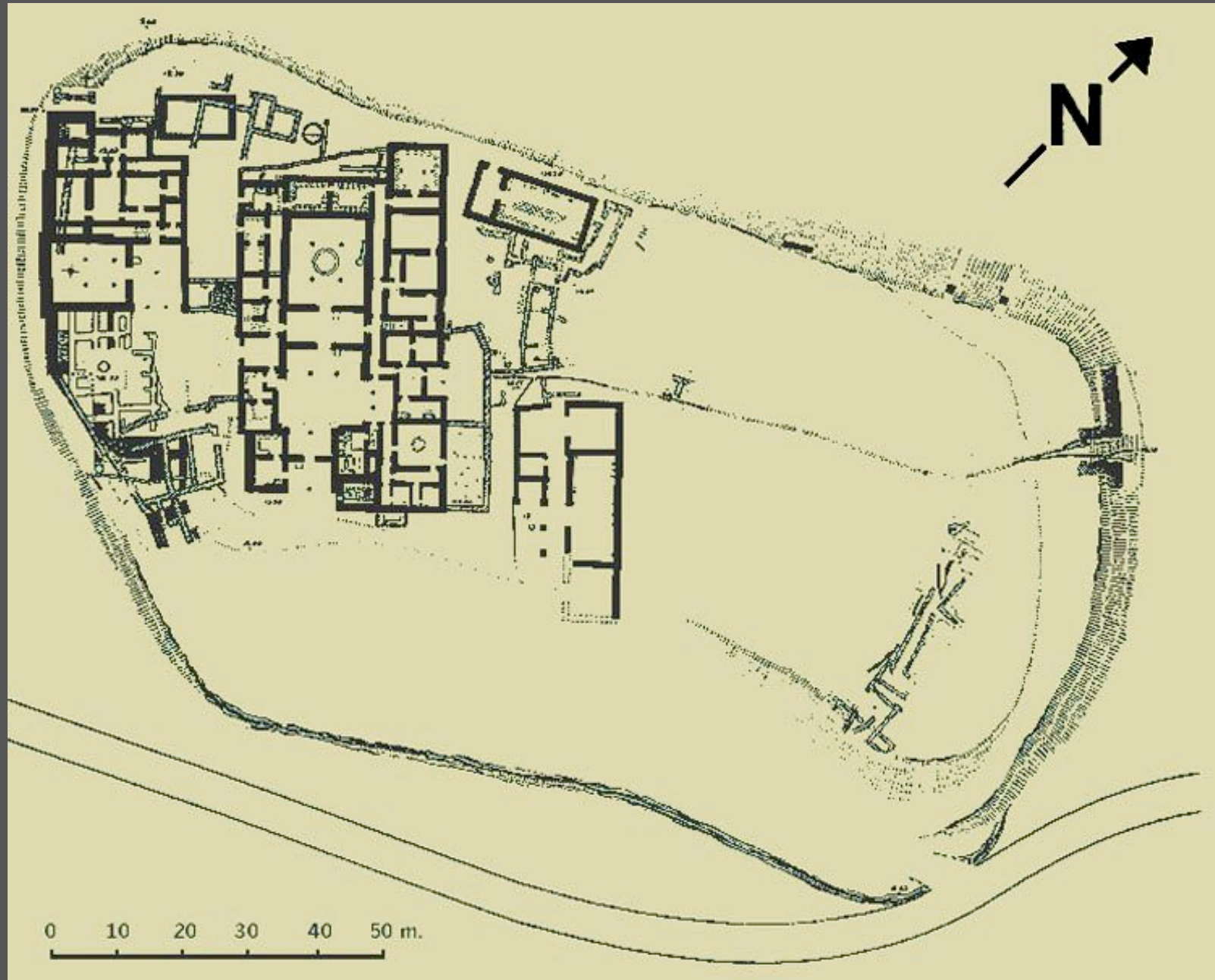

Plan of the “Palace of Nestor” (Pylos)

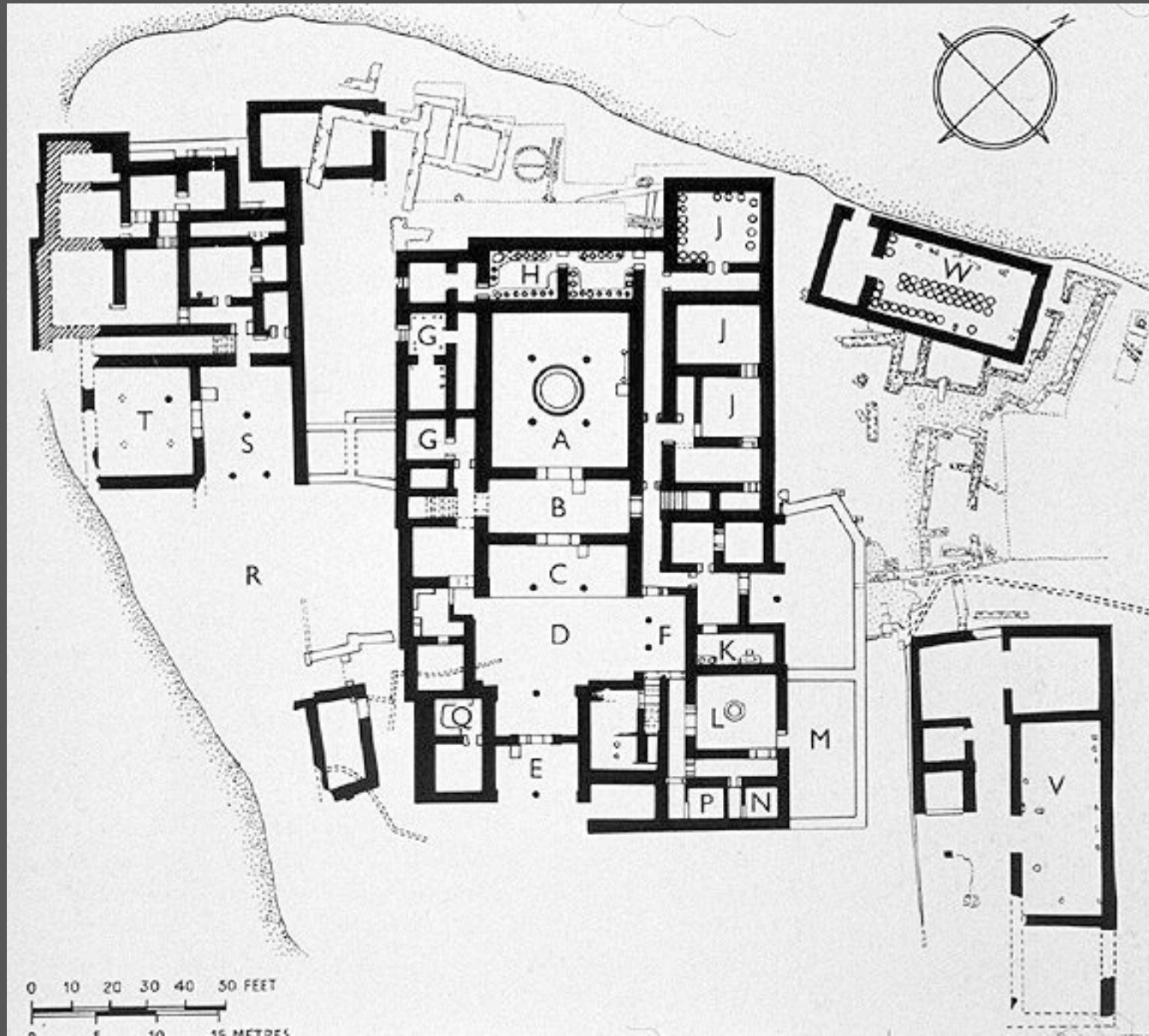

- A – megaron
- B – vestibule
- C – porch
- D, M, R – courtyards
- E – propylon
- F – columned porch
- G – pantries
- H, J, W – storerooms
- K – bathroom
- L – queens megaron
- N – boudoir
- P – lavatory
- Q – archives room

Pylos: “Queen’s Megaron” and “bathroom”



Reconstruction drawing of the megaron at the palace of Nestor

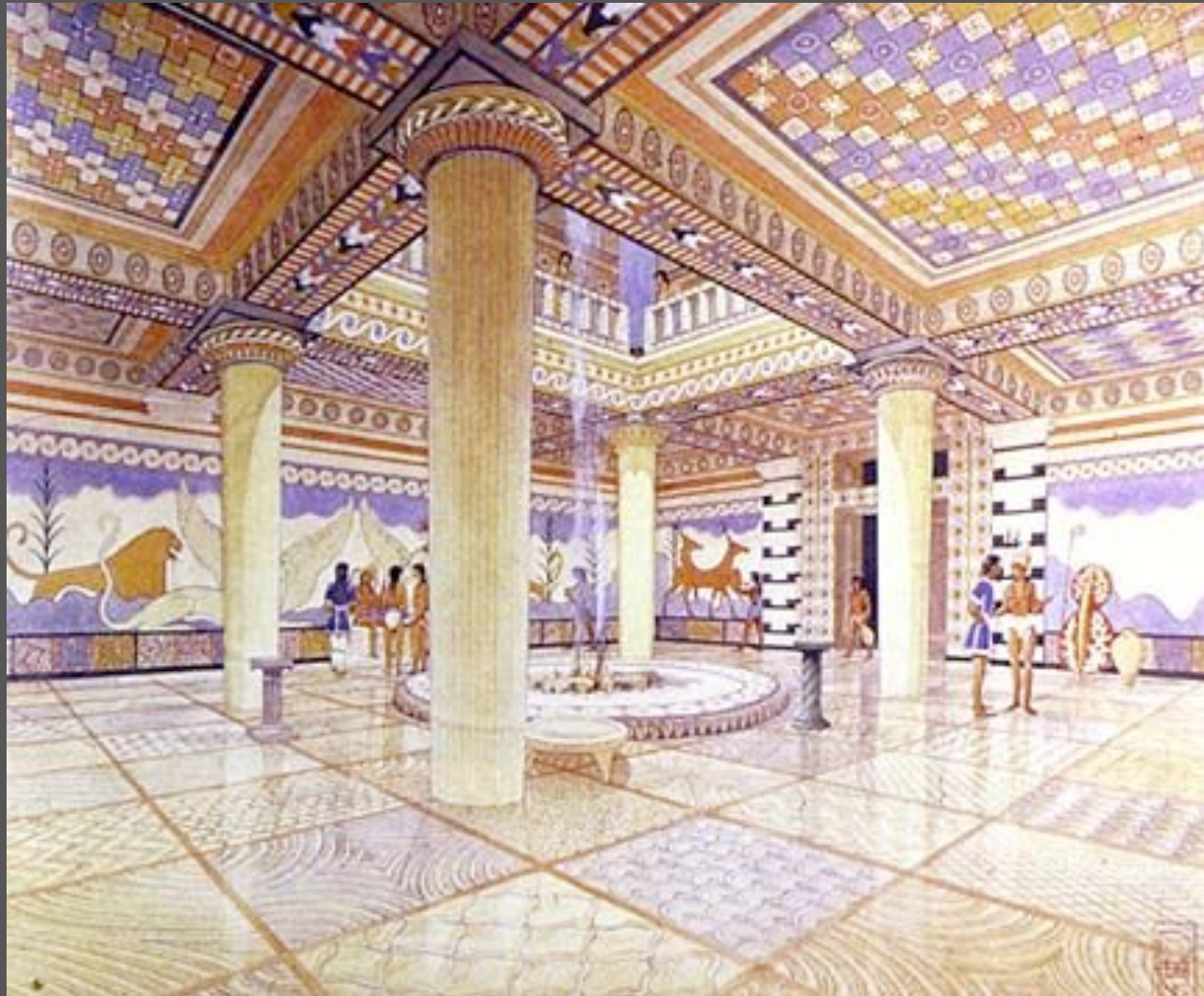

Pylos: terracotta bathtub



Plan of the citadel at Tiryns and the palace complex

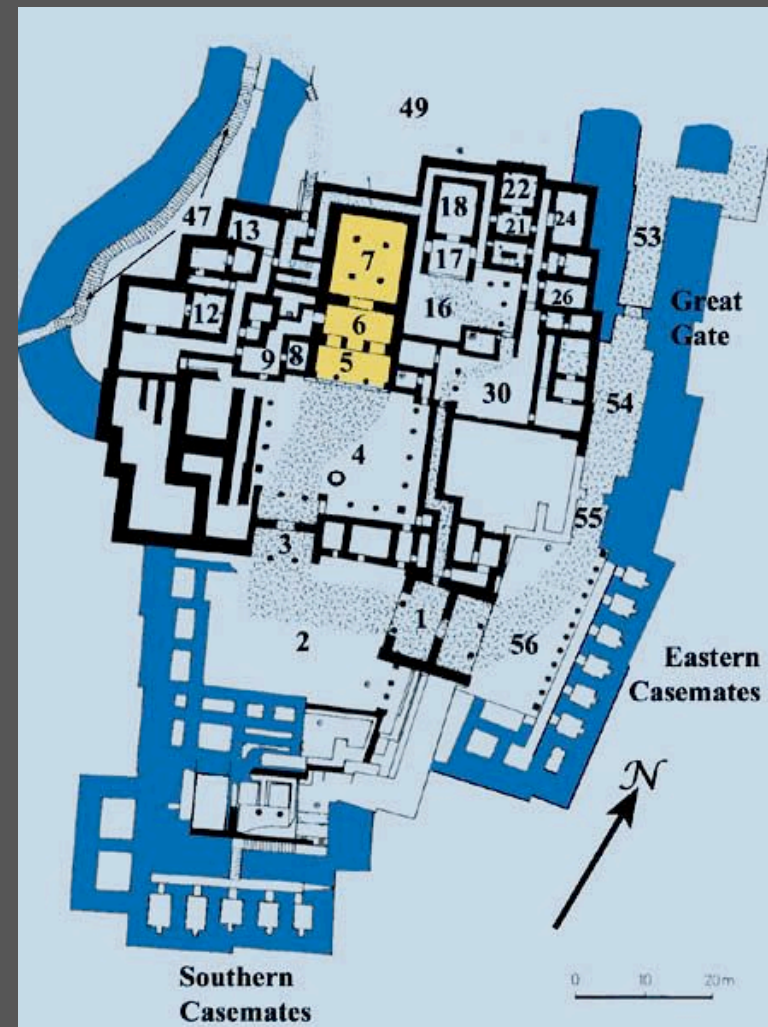
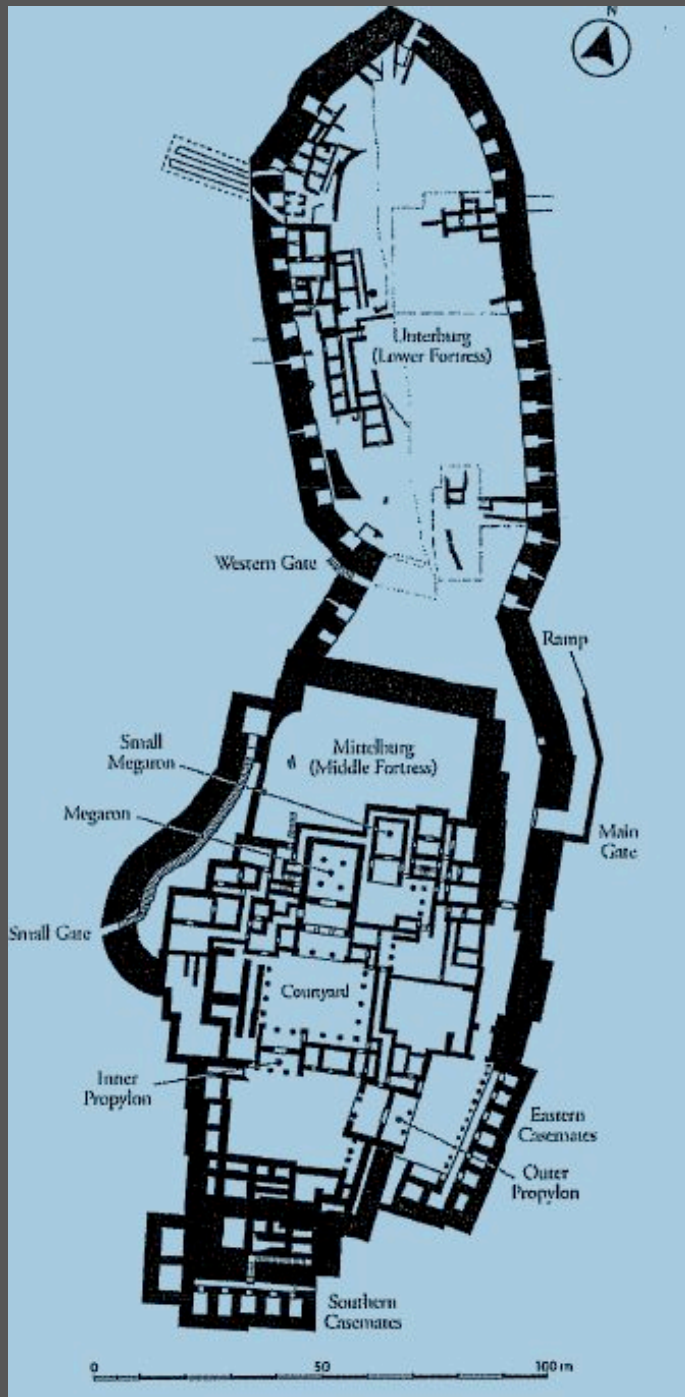

Aerial view of the palace at Tiryns, from the South



Tiryns: Interior of the eastern casemates



View of the citadel at Mycenae from the east



Mycenae: aerial view and reconstruction of the site and citadel

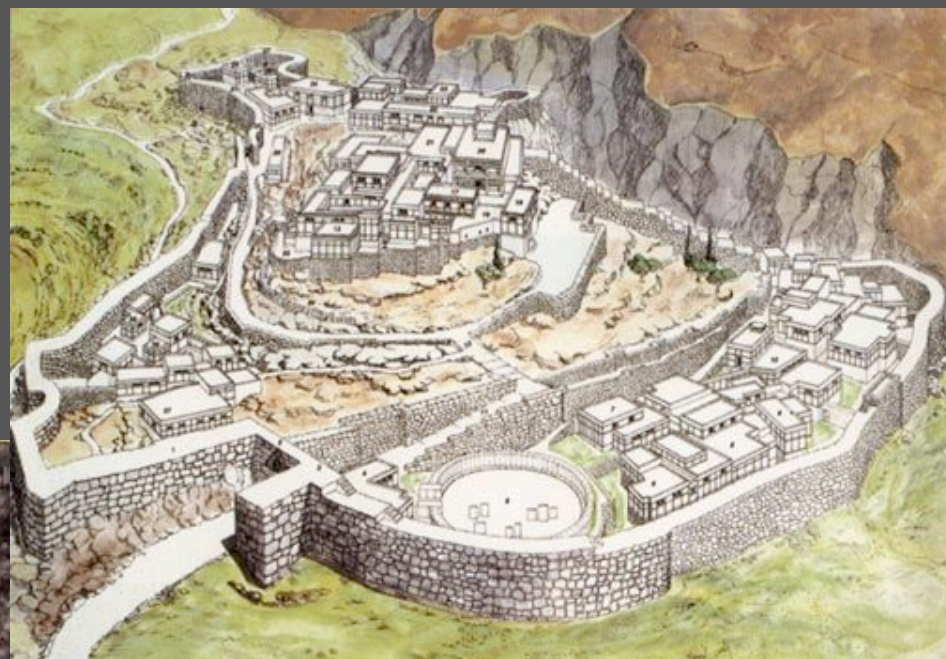

Approach to Mycenae: the Lion Gate



Plan of the site of Mycenae

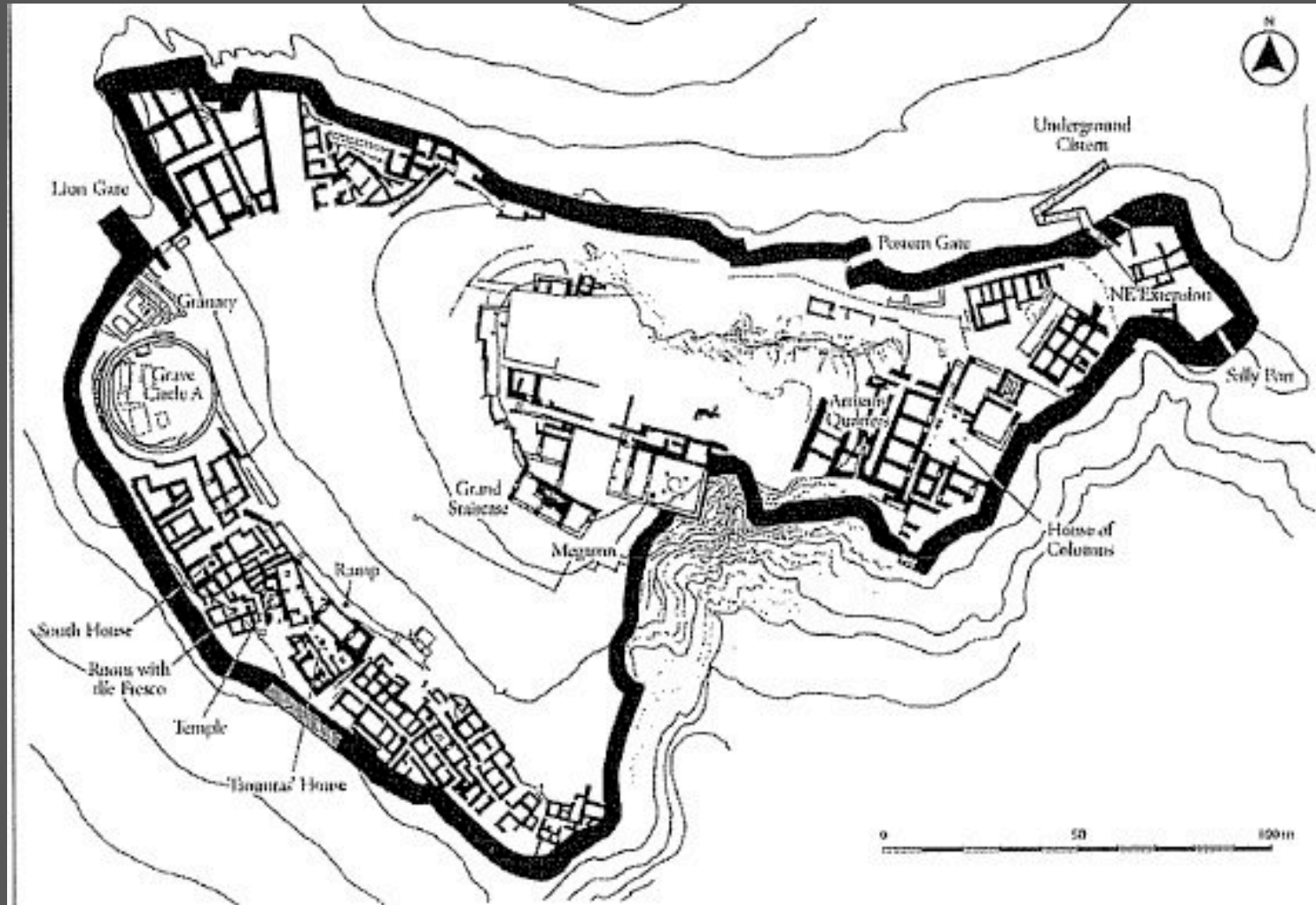

Mycenae: Plan of the cult area

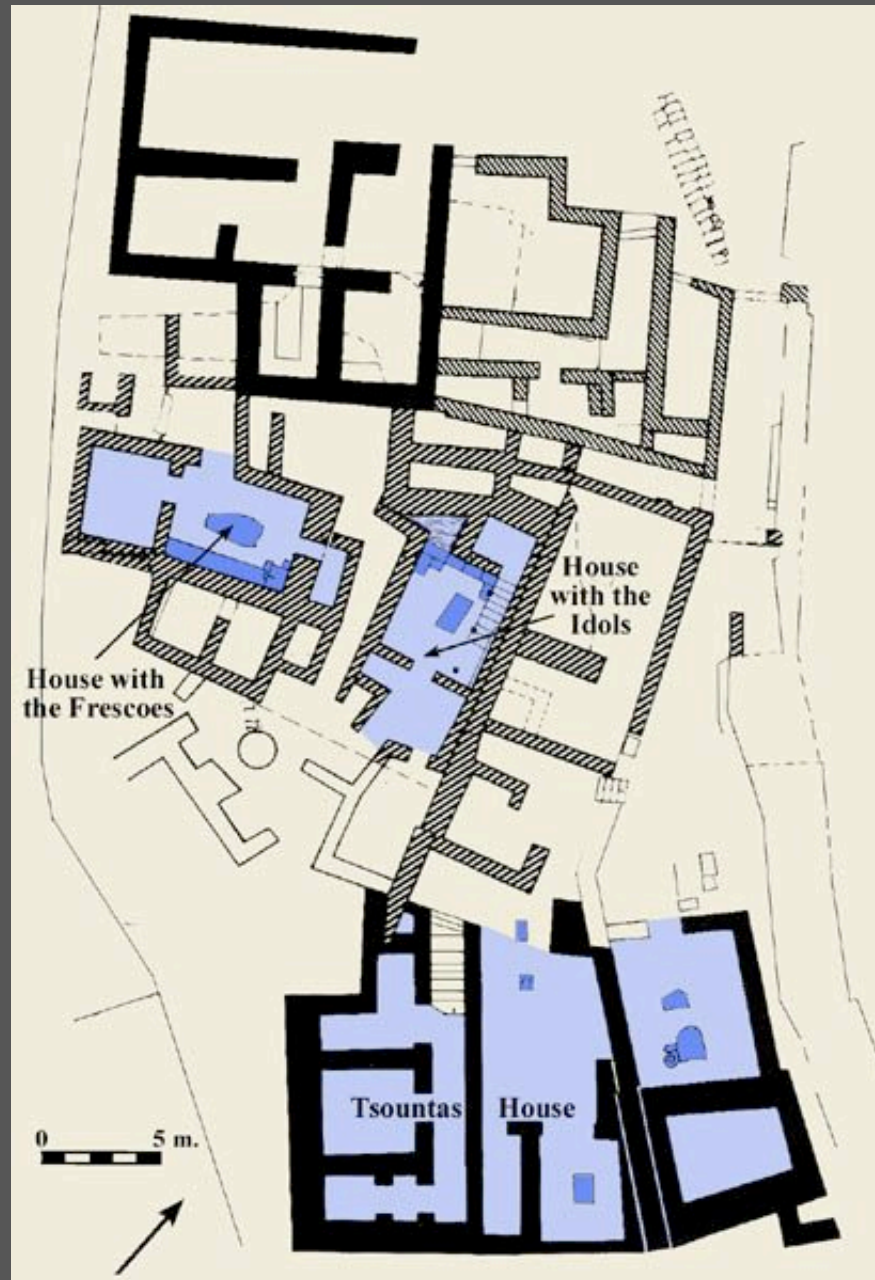

Mycenae: plan of the palace

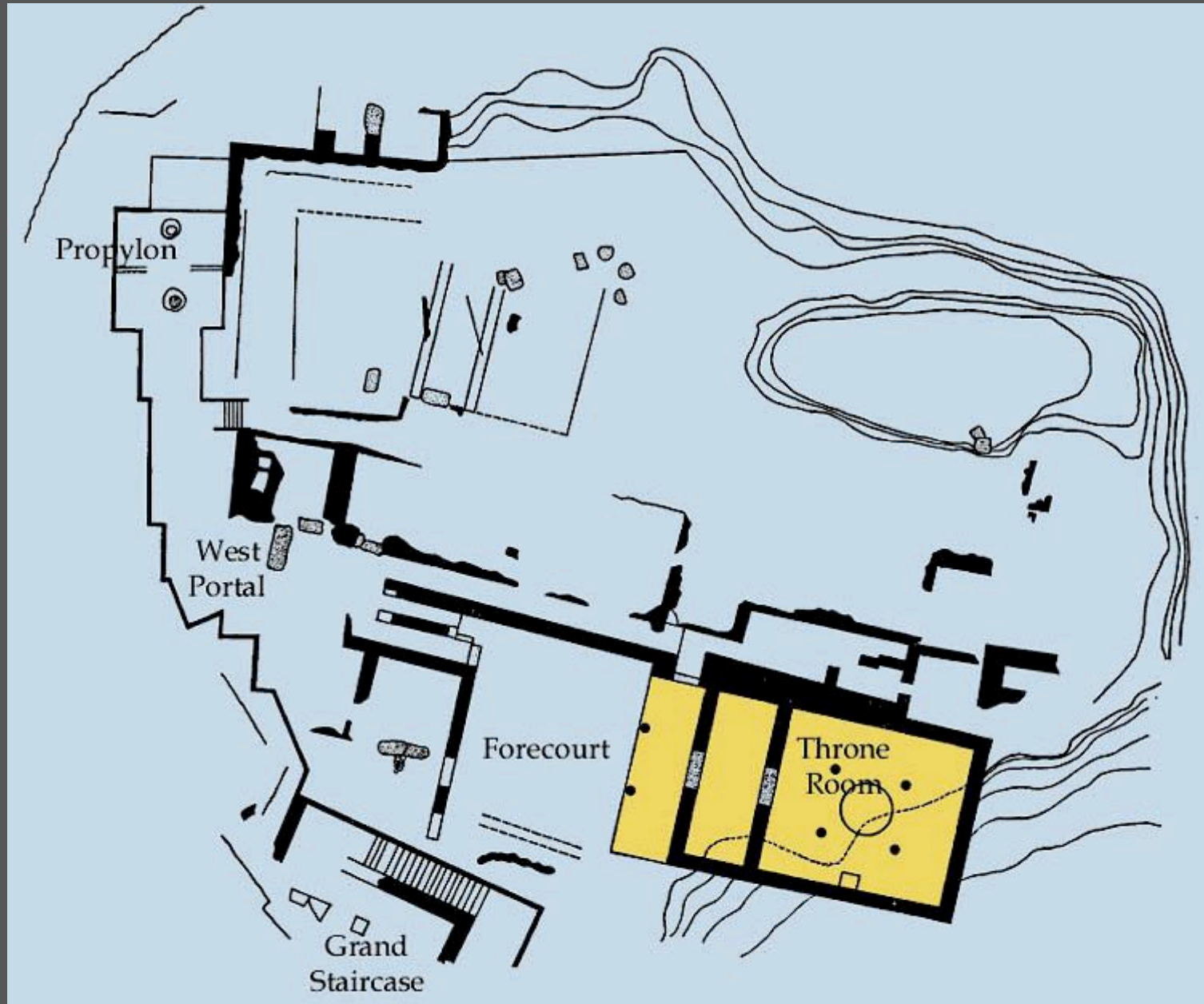

Mycenae: fresco of priestess with sheaves of wheat



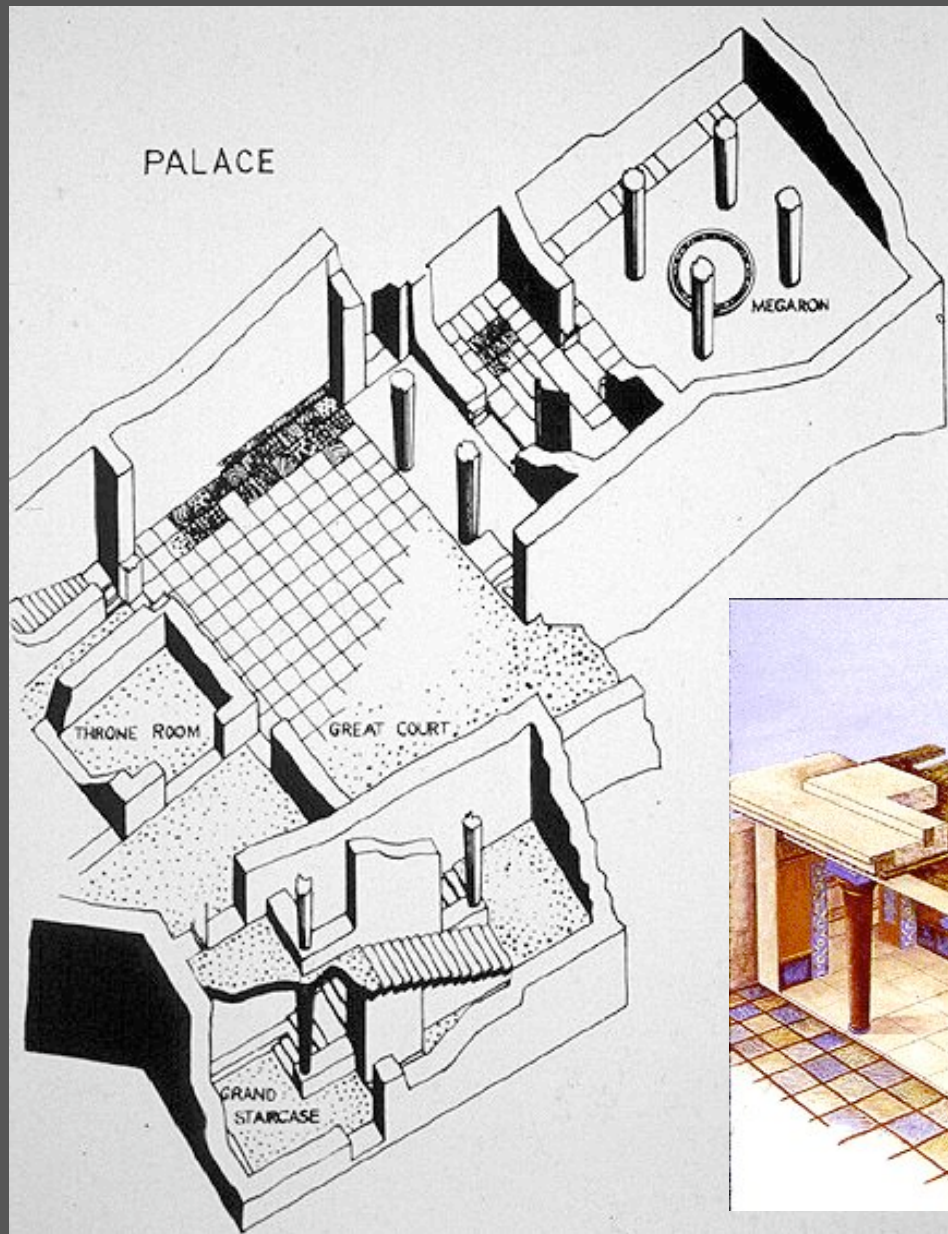

Isometric plan and reconstruction of the palace at Mycenae and the megaron

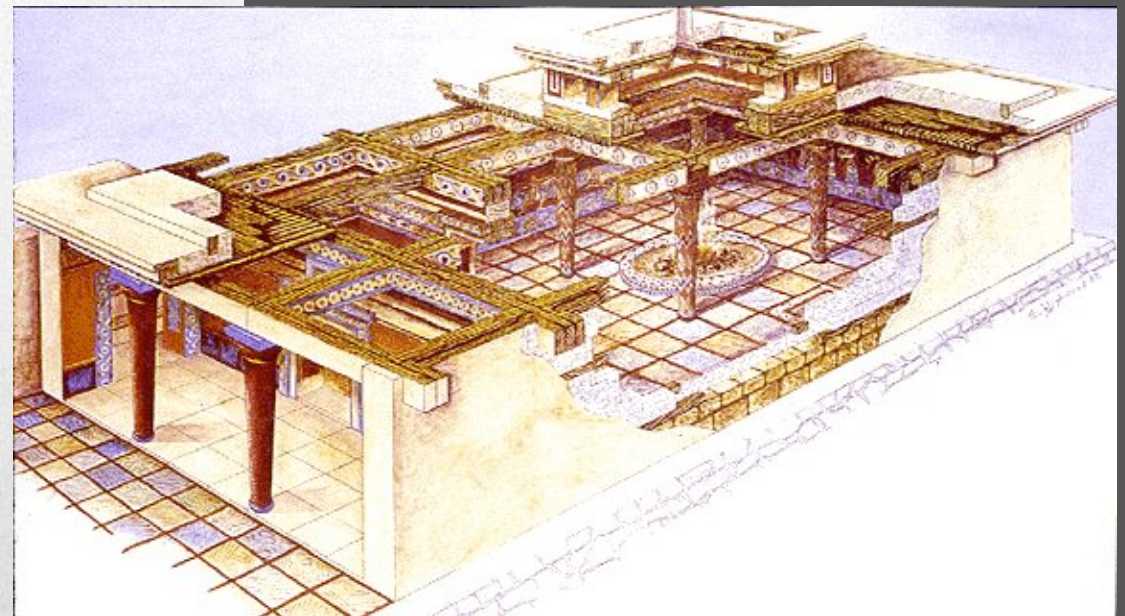

Plan of the houses outside the citadel at Mycenae

